

# IQTOUCH TB800 Series



IQTouch TB800 series is designed to make your meeting more effective. With interactive 20-point touch and built-in wireless screen mirroring software for content sharing, IQTouch TB800 series is helpful for facilitating presentations, brainstorming, and decision-making. All you need in a meeting are seamlessly integrated into the interactive display, just walk in and get your meeting started.

## Specifications

Name	IQTouch TB800 Series		
Model	LE065MD	LE075MD	LE086MD
Diagonal Size	65"	75"	86"
Backlight	DLED	DLED	DLED
Resolution	3840*2160	3840*2160	3840*2160
Brightness (typ)/(min)	350cd/m <sup>2</sup>	350cd/m <sup>2</sup>	350cd/m <sup>2</sup>
Contrast Ratio(typ)/(min)	1200:1	1200:1	1200:1
Response Rate (typ)/(min)	8ms	8ms	8ms
Display Ratio	16:9	16:9	16:9
Refreshing Frequency	60Hz	60Hz	60Hz
Viewing Angle	178°(H), 178°(V)	178°(H), 178°(V)	178°(H), 178°(V)
Backlight Life Time (typ)/(min)	50,000 hrs	50,000 hrs	50,000 hrs
Color Saturation (x% NTSC)	65%	65%	65%
Display Area(mm)	1428.48(H)*803.52(V)	1649.66(H)*927.94(V)	1895.04(H)*1065.96(V)
Depth of Color	1.06Billion(10Bit)	1.06Billion(10Bit)	1.06Billion(10Bit)

Power Supply			
Voltage	AC100-240V,50-60 Hz	AC100-240V,50-60 Hz	AC100-240V,50-60 Hz
Maximum Power	≤180W	≤320W	≤380W
Standby Power	≤0.5W	≤0.5W	≤0.5W

Physical			
Net Weight	47.8Kg	61.8Kg	74.4Kg
Gross Weight	59.8Kg±1 Kg	75Kg±1 Kg	95Kg±1 Kg
Product Size (W*H*D)(mm)	1485*897.5*91.6	1707.1*1022.7*93.2	1953.4*1161.4*92
Packing Size (W*H*D)(mm)	1660*1045*245	1860*1190*265	2140*1340*280
Housing Material	Metal	Metal	Metal
Frame Color	Black	Black	Black
VESA Hole Position(mm)	4-M8 screw hole 400*500	4-M8 screw hole 400*600	4-M8 screw hole 400*750

<b>Front Interfaces</b>	
USB 3.0	1
USB 2.0	1
Buttons	1

<b>Output Interfaces</b>	
SPDIF (COAX)	1
HDMI	1
EARPHONE	1
AV	1

<b>Language</b>	
OSD	English, Chinese

<b>Environmental</b>	
Working Temperature	0°C ~ 50°C
Storage Temperature	-20°C ~ 60°C
Working Humidity	20% ~ 80% RH Non-Condensing
Storage Humidity	10% ~ 90% RH Non-Condensing
Maximum Working Hours(Hours/Day)	24H / 7D

<b>Input Interfaces</b>	
RJ45	1
HDMI	2
VGA	1
AV	1
PC-AUDIO	1
YPBPR	1
TOUCH-USB	1
USB2.0	1
USB3.0	1
RS232	1
TF	1

<b>OPS Interfaces (Optional)</b>	
USB2.0	2
USB3.0	2
LAN	1
HDMI	1
LINE-OUT	1
MIC-IN	1

<b>Functions</b>	
Hotspot	YES
Built-in Speakers	10W*2
Power Input	1
Power Switch	1
Video Format	NTSC、PAL、 SECAM、DTMB

<b>OPS (Optional)</b>	
Chipset	Intel
CPU	Intel® Mobile Core TM i7/i5/i3 and Celeron® Processor
Memory	4GB/8GB/16GB
HDD	500G/1T
SSD(optional)	128G

<b>Android</b>		
CPU	Framework	Dual-core A73 and dual-core A53
	Dominant Frequency	1.5GHz
	Cores	Quad-Core
GPU		MaliG51 *4
RAM		4GB DDR3
ROM		32GB
OS Version		Android 8.0

<b>Touch</b>	
Technology	Infrared
Glass	Anti-Glare Tempered Glass
Physical Resolution	32768*32768
Response Rate	< 10ms
Positioning Accuracy	Middle part of the screen ≤1mm, sides of the screen ≤2mm
Input Way	Finger, Pen
Touch points	20
Writing Height	.3.5mm
Minimum Touch Object Detect	5mm

**IQTouch 65"**

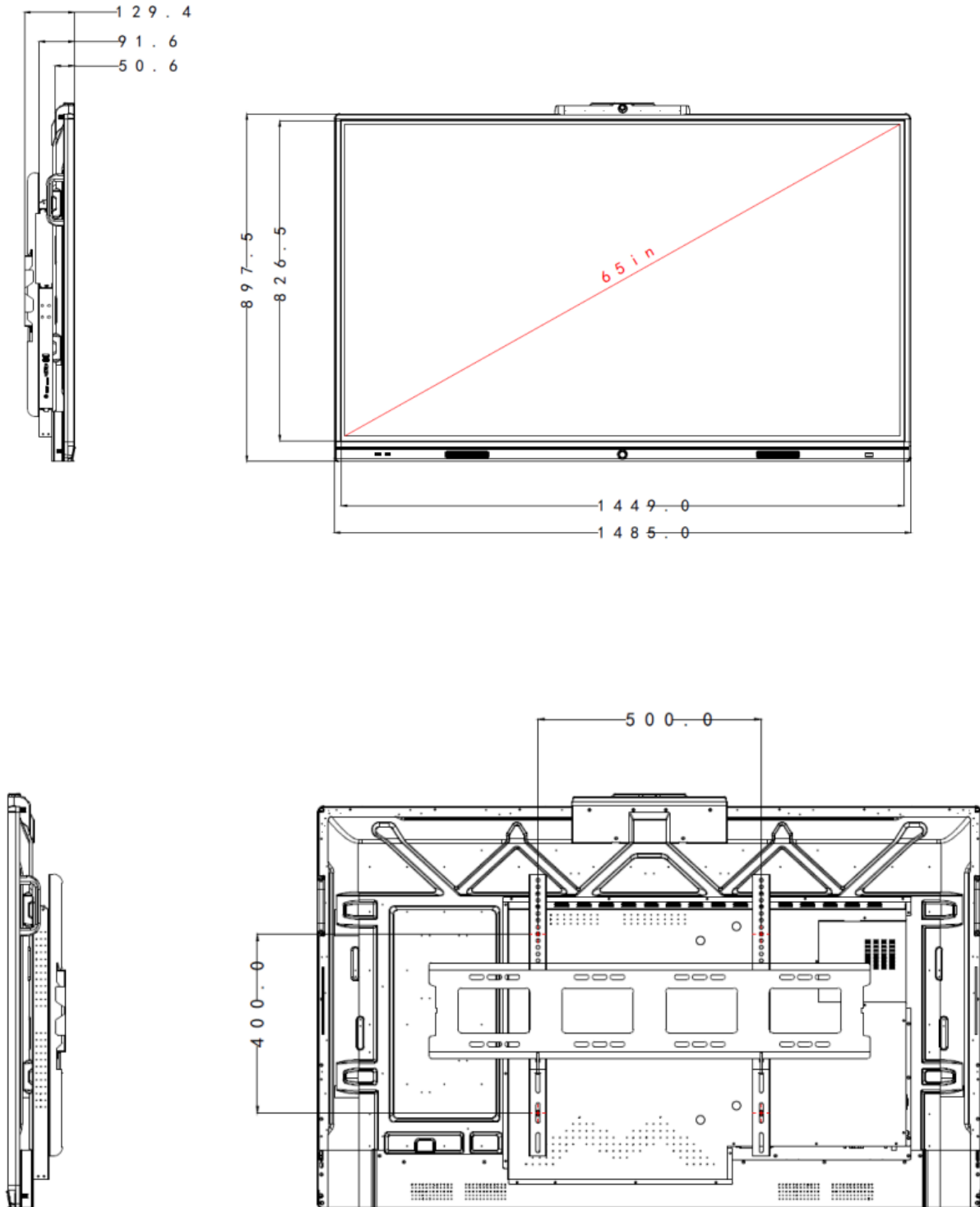

**IQTouch 75"**

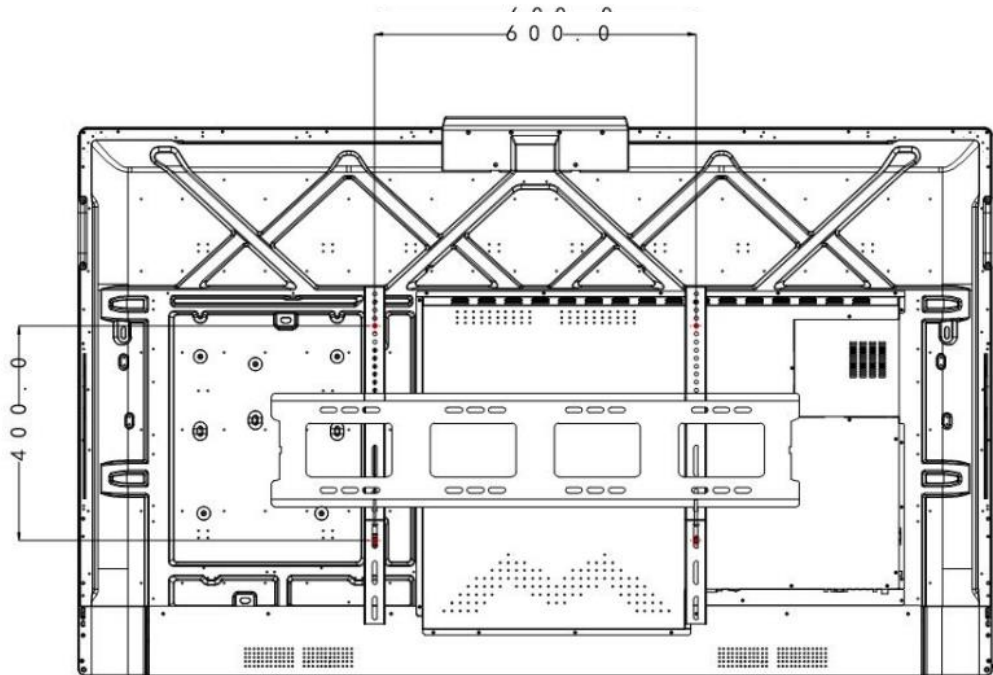
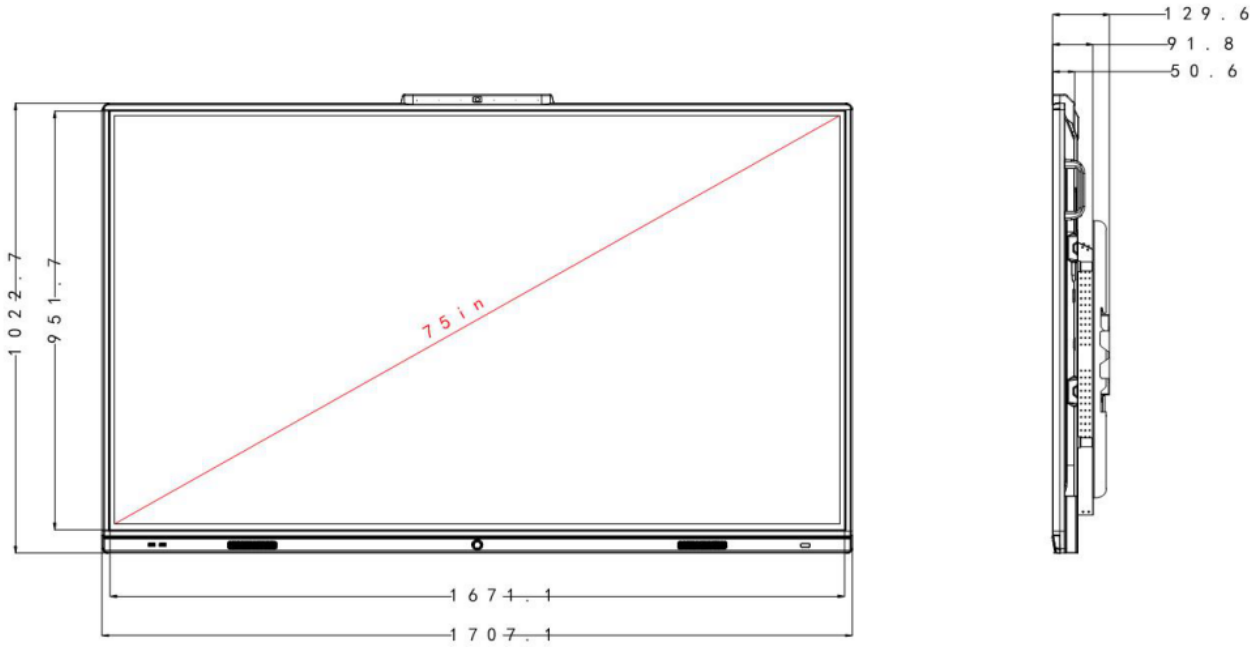

**IQTouch 86"**

